

RoHS2.0
Compliant

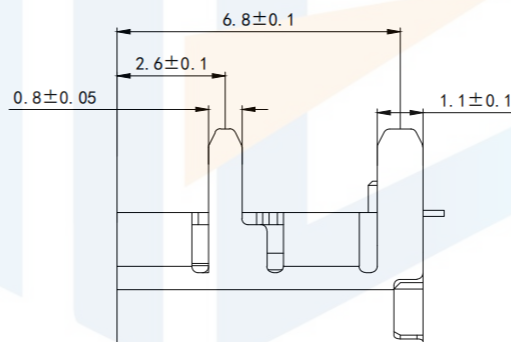
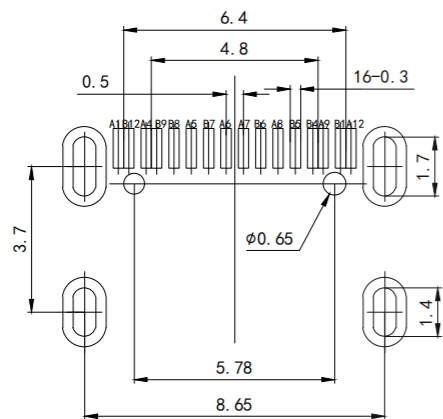
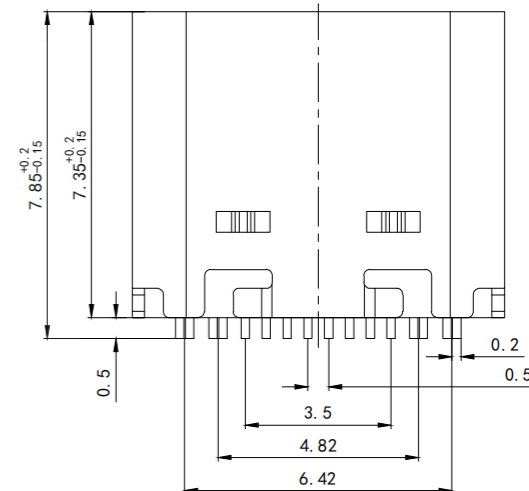
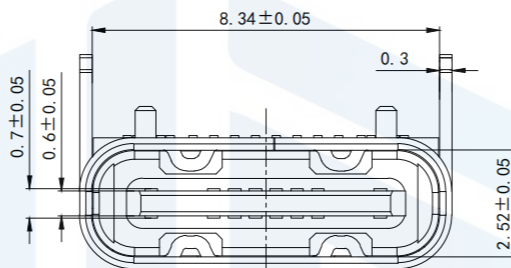
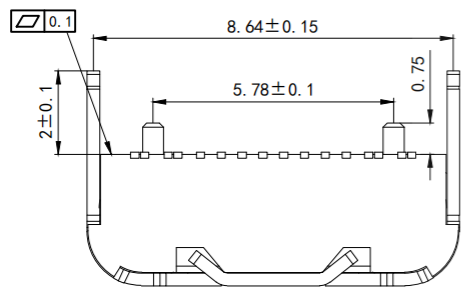

A1	GND	B12	GND
A4	VBUS	B9	VBUS
A5	CC1	B8	SBU2
A6	D+	B7	D+
A7	D-	B6	D-
A8	SBU1	B5	CC2
A9	VBUS	B4	VBUS
A12	GND	B1	GND
PIN	SIGNAL NAME	PIN	SIGNAL NAME

Step 1: Materials

- A. Body :LCP, black, white, UL 94-V0;
- B. Terminal: copper alloy, electroplating brush gold;
- C. Shell: stainless steel, nickel plated;
- D. Middle clip: stainless steel.

2. Main features

- A. Voltage level :20V AC;
- B. Current :5A;
- C. Working temperature :-40'c~85'c;
- 3. Electrical requirements:

A. Contact resistance: 40ma Max(initial),50ma Max. (Last) B. Voltage :100V AC 1 min; C. Insulation resistance :100mmin. DC500v;

4. Mechanical properties:

- A. Insertion force :5~20N. (from 1 to 10,000 times); B. Pullout force :8 to 20N. (from 1 to 1,000 times); 6~20N. (from 1,001~10,000 times);
- C. Durability life :10,000 times;

TOLERANCE

X. XXX	±0.05
X. XX	±0.15
X. X	±0.20
X.	±0.30
ANGLE	±5.0°

PROTECTON

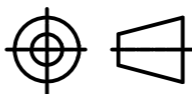

东莞市恒祺电子科技有限公司

Dongguan Hengqi Electronic Technology Co., Ltd

<https://www.hq-dz.com>

phone:15812872448

TITLE:

TYPE C 16P板上端子SMT
4定位脚长2.0插板H=7.35

PART NO:TYPE-C16P-BS082

DRAWING NO:7.35*8.34*3.16

DRAWN:

CHECKED:

APPROVED:

DATE:

18-10-08

UNIT:
mm

DATE:

18-10-08

SCALE:
FULL

DATE:

18-10-08

SIZE:
A4