

RoHS2.0
Compliant

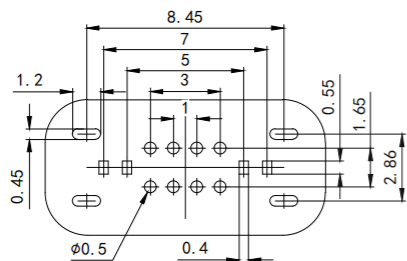

RECOMMEND P. C. B LAYOUT (COMPONENT SIDE)
TOLERANCE FOR PCB LAYOUT IS ± 0.05

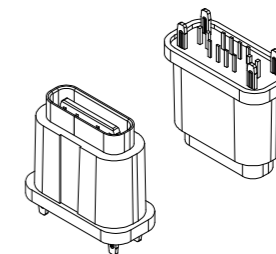
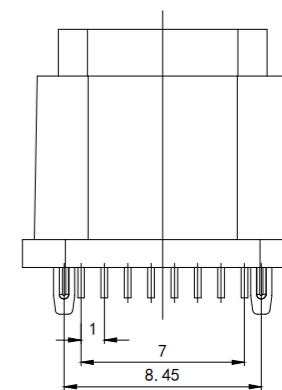
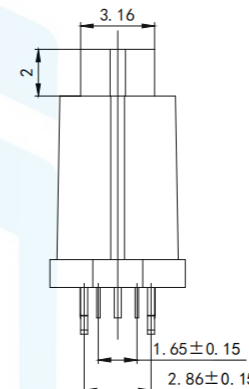
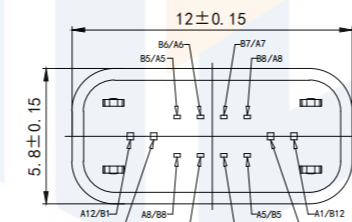
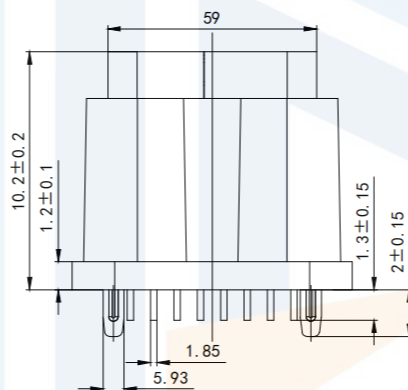
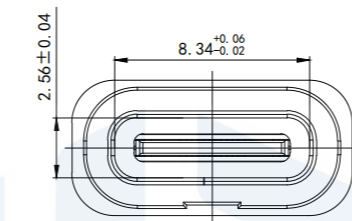

NOTE:

1. Electrical characteristics:
 - 1.1. Contact area: contact resistance 40mΩ Max, allowing 10mΩ variation
Test conditions :20mv, 100mA measurement.
 - 1.2. Contact current: 3A VBUS pin; 1.25A for GND Pin; The other pins are 0.25A.
 - 1.3. Rated voltage: 5V.
 - 1.4. Withstand voltage: 100VAC.
 - 1.5. Insulation resistance: at least 100 megohm.
2. Mechanical properties:
 - 3.1. Insertion force: 0.5-2.0Kg (REF)
 - 3.2. Drawing power: 0.6-2.04Kg (REF)
 - 3.3. Insertion and removal times: 10000 times.
 4. Working environment: -20°C to +85°C.

TOLERANCE	X. XXX	±0.05		东莞市恒祺电子科技有限公司 Dongguan Hengqi Electronic Technology Co., Ltd	
	X. XX	±0.15		https://www.hq-dz.com phone:15812872448	
PROTECTON	X. X	±0.20		TITLE: TYPE C 16P立式插板防水母座H10.2	
	X.	±0.30		PART NO: TYPE-C16P-LC102FS	
	ANGLE	±5.0°		DRAWING NO: 12*5.8*10.2	
			DRAWN:		DATE: 18-10-08
			CHECKED:		DATE: 18-10-08
			APPROVED:		DATE: 18-10-08
					UNIT: mm
					SCALE: FULL
					SIZE: A4